

# 5 LED VOLTMETER



- Economic Voltmeter constituted by 5 red LEDs suitable for use on generating sets or any net subjected to vibrations.
- This device is available in horizontal (2RI33V230) and vertical (2RI33V230T) version able to read voltage at 230V, or in horizontal (2RI33V400) and vertical (2RI33V400T) version able to read voltage at 400V, (but referred to 230VAC auxiliary power supply)
- Instrument measures phase-neutral voltage **only (230V)**.  
The same instrument can show the measure of 400V (model 2RI33V400 and 2RI33V400T), but in any case the connection must be linked to 230V ( $230V \times \sqrt{3} = 400V$ )



## TECHNICAL CHARACTERISTICS

■ Auxiliary power supply U	self supplied	Frequency range	45...65Hz
■ Range	40...300VAC	■ Nominal temperature	-5 ... +80 °C
■ Max absorbed power	0,5VA	■ Protection degree	IP40
■ Voltmeter circuit		■ Standards CEI	- Safety CEI EN 61010-1 300V CLASS III - Accuracy class CEI EN 60688
■ Direct insertion	max 300V	■ <b>PATENTED INSTRUMENTS VA/2006/A/33</b>	
■ Thermic overload	400V for 5 seconds		

## DIMENSIONS in mm

■ Weight: 0,01 kg

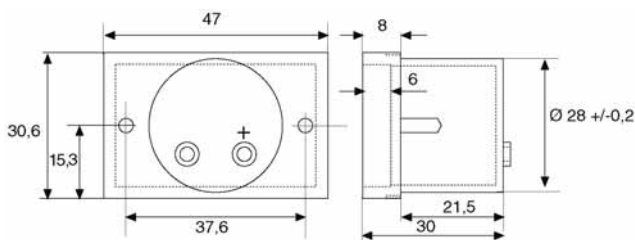

## QUICK FIXING SYSTEM



## CONNECTION DIAGRAM

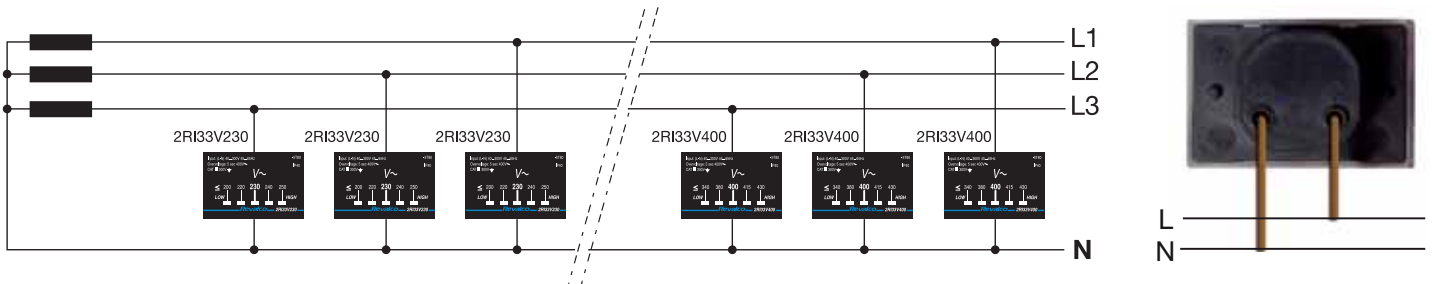

# LED INDICATORS

2RI36VH 230



2RI36VH 400



## CARACTERISTIQUES TECHNIQUES

- These instruments make it possible to adjust the voltage and frequency in small electronic units. As it is possible to replace the voltmeter and frequency meter there is a considerable saving from an economical point of view as well as space on the electrical switchboard.
- **BURDEN** 0,5VA
- **ACCURACY CLASS** 1%
- **DISPLAY** by 2 groups of 3 leds electronic circuit each
- **STANDARD POWER SUPPLY** selfpowered 230V/50Hz +/-10%
- The standard instruments are calibrated at 230V and 50Hz
  - If the electronic unit delivers 230V at 50Hz the green Led lights up
  - If there is a drop in the voltage of the above-mentioned data, the yellow Led lights up (while the green Led remains light)
  - If on the other hand there is an increase in the above-mentioned data, the red Led lights up (while the green Led remains light)
  - In order to restore the normal values it is sufficient to accelerate or slow down the speed of the electronic unit motor until the yellow or red Leds go out.
- **EXAMPLE WHEN ORDERING**
  - 2RI36VH 230V 50Hz indicator (36x72mm) 230V input, phase-neutral connection (reading from 210 to 250V) operating frequency 50Hz input (reading from 48 to 52 Hz)
  - 2RI36VH 400V 50Hz indicator (36x72mm) 230V input, phase-neutral connection (reading from 380 to 420V) operating frequency 50Hz input (reading from 48 to 52 Hz)
- in a three phase system, the phase-neutral connection (230V) is comparable to a phase-phase connection (400V)
- **DIMENSIONS / WEIGHT (kg):** 36x72x61mm / 0,20

## CONNECTION DIAGRAMS

